

表面貼電源電感

Surface Mounted Power Inductors

Model	A(mm)	B(mm)	C(mm)	D(mm)	Specification
MC-3317	3.3±0.5	Max2.0	12.5±3.0	4.0±1.0	<ul style="list-style-type: none"> Inductance range(電感範圍) 100nH~8000000nH Working frequency(可工作頻率) ~100MHz Working current(可工作電流) ~2A Working temperature(可工作溫度) -40℃~85℃
MC-3320	3.3±0.5	2.0±0.5	12.5±3.0	4.0±1.0	
MC-3820	3.8±0.5	2.0±0.5	12.5±3.0	4.0±1.0	
MC-4517	4.5±0.5	Max2.0	12.5±3.0	4.0±1.0	
MC-4520	4.5±0.5	2.0±0.5	12.5±3.0	4.0±1.0	
MC-4931	4.9±0.5	3.1±0.5	12.5±3.0	4.0±1.0	
SM-2910BT	5.7±0.75	3.3±0.5	1.4Max		<ul style="list-style-type: none"> Inductance range(電感範圍) 100nH~5000000nH Working frequency(可工作頻率) ~100MHz Working current(可工作電流) ~20A Working temperature(可工作溫度) -40℃~85℃
SM-3317T	5.7±0.75	3.3±0.5	2.0±0.5		
SM-3820T	5.7±0.75	3.8±0.5	2.5±0.5		
SM-4233T	6.8±0.75	4.2±0.5	5±0.25		
SM-4931T	6.8±0.75	4.9±0.5	Max3.5		
SDR32	3.1 MAX	2.1±0.3	3.5±0.3	1.5±0.3	<ul style="list-style-type: none"> Inductance range(電感範圍) 100nH~5000000nH Working frequency(可工作頻率) ~100MHz Working current(可工作電流) ~20A Working temperature(可工作溫度) -40℃~85℃
SDR43	4.6 MAX	3.2±0.3	4.5±0.3	1.5±0.3	
SDR54	5.5 MAX	4.5±0.3	5.8±0.3	2±0.3	
SDR73	7.3 MAX	3.5±0.3	7.8±0.3	2.5±0.3	
SDR75	7.3 MAX	5.0±0.3	7.8±0.3	3±0.5	
SDR105	9.3 MAX	5.4±0.3	10±0.3	3±0.5	
SDO1608	6.6 MAX	4.5 MAX	2.9 MAX	1.02±0.3	<ul style="list-style-type: none"> Inductance range(電感範圍) 1nH~100000nH Working frequency(可工作頻率) ~10GHz Working current(可工作電流) ~5A Working temperature(可工作溫度) -40℃~85℃
SDO51608	6.6 MAX	4.5 MAX	2.9 MAX	1.02±0.3	
SDO3316	13 MAX	9.4 MAX	5.2 MAX	2.54±0.3	
SDO3316	13 MAX	9.4 MAX	5.3 MAX	2.54±0.3	
SDO5022	18.5 MAX	15.2 MAX	7.1 MAX	2.54±0.3	
SDO5022	18.5 MAX	15.2 MAX	7.6 MAX	2.54±0.3	
160809(0603)	1.6±0.2	0.8±0.2	0.2~0.6	0.8±0.2	<ul style="list-style-type: none"> Inductance range(電感範圍) 1nH~100000nH Working frequency(可工作頻率) ~10GHz Working current(可工作電流) ~5A Working temperature(可工作溫度) -40℃~85℃
201209(0805)	2±0.2	1.25±0.2	0.2~0.8	0.9±0.2	
252016(1008)	2.5±0.2	2±0.2	0.4~1.0	1.6±0.2	
3216(1206)	3.2±0.2	1.6±0.2	0.4~1.0	1.1±0.2	
322513(1210)	3.2±0.2	2.5±0.2	0.6~1.0	1.3±0.2	
451616(1806)	4.5±0.2	1.6±0.2	0.6~1.0	1.6±0.2	
453215(1812)	4.5±0.2	3.2±0.2	0.6~1.0	1.5±0.2	



典型應用回路(例):
TYPICAL APPLICATION CIRCUIT(EXAMPLES):

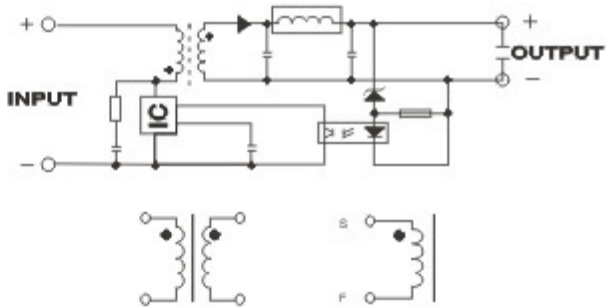

中英文說明	Specific Property 特性	Application 用途
	Small Size, Low DC Resistance, High rated current Unshield or Shield type can be obtained; Reel package suitable for automatic assembly.	Electronic watch sound and Light Siren buzzer, Power Switch.
	體積小, 低阻抗, 耐大電流, 受溫度影響小, 卷帶包裝適合自動插件。	電子表發聲及發光蜂鳴器, 電源開關等。

歡迎客戶提供規格 CUSTOMER SPECIFICATION IS WELCOME

表面貼電源電感

Surface Mounted Power Inductors

SMT POWER INDUCTORS

PACKAGING SPECIFICATION FOR SMT POWER INDUCTORS SPECIFICATIONS OF REEL & PACKING UNIT

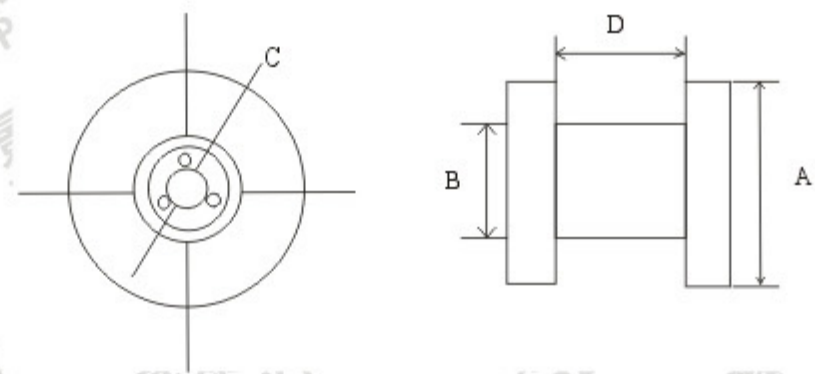
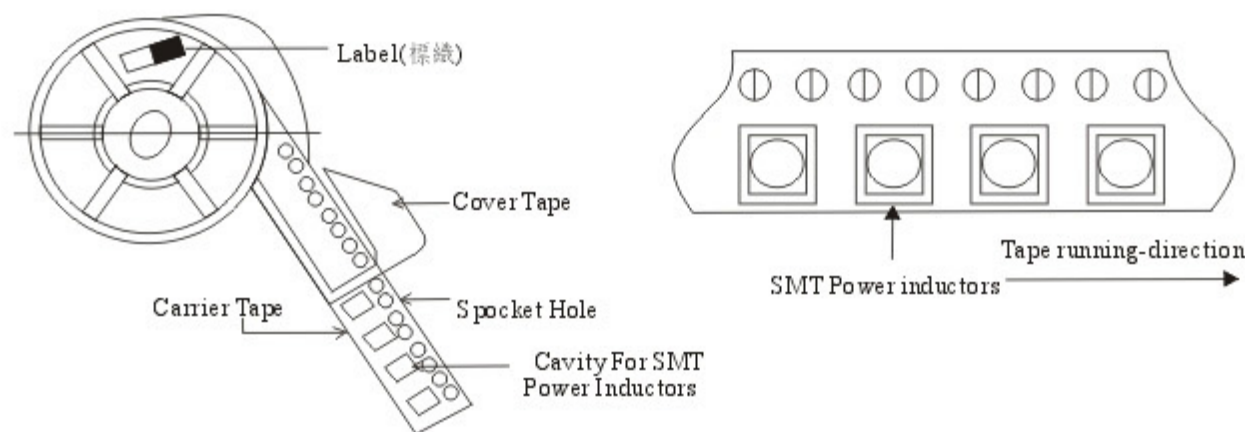

ITEM NO	DIMENSIONS OF REEL				PACKING Qty(PCS/R)
	A	B	C	D	
SDS-125D	330±3	75.0±2.00	13.50±0.50	25.0	500
SDS-127D	330±3	75.0±2.00	13.50±0.50	25.0	500
1210-1206	178±3	60~75	13±1	14	1000
0603-0805	178±3	60~75	13±1	10	4000

歡迎客戶提供規格 CUSTOMER SPECIFICATION IS WELCOME